

# IN5500 (SERIES)

**InFocus**  
Bright Ideas Made Brilliant

## Simply Stunning

Ease of Use - Sophisticated Features  
Elegant Styling - Stunning Image Quality



# IN5500 (SERIES)

## Outshine the brightest.

Offering best-in-class performance and a wealth of features, the IN5500 series projectors use DLP® DarkChip technology and InFocus' award-winning BrilliantColor™ implementation, and offer up to WUXGA (1920 x 1200) resolution. These projectors are ideal for demanding professional applications requiring flexible lens options. With rich connectivity and embedded networking, the IN5500 series also features a filter-free design for fail-safe 24/7 operation. Customizable skins and an integrated cable management give the IN5500 a sleek, elegant profile to complement any venue. And with a high brightness of up to 7000 lumens, any audience will sit up and take notice.

### IN5502

WXGA (1280 x 800) DLP® DARKCHIP™  
SINGLE 330W LAMP  
Ideal WXGA integration projector.

### IN5504

WUXGA (1920 x 1200) DLP® DARKCHIP™  
SINGLE 330W LAMP  
HD flexibility at it's finest.

### IN5532

WXGA (1280 x 800) DLP® DARKCHIP™  
DUAL 330W LAMP, LIQUID COOLED DMD  
For installations requiring fail-safe 24/7 operations.

### IN5534

WUXGA (1920 x 1200) DLP® DARKCHIP™  
DUAL 330W LAMP, LIQUID COOLED DMD  
Dual lamps and a full range of lens options.

### Custom Skins

Choose your cover. With options in Matte Black, Matte White, Glossy Black, Walnut, or pre-primed custom skins, the IN5500 series blends beautifully with any décor.



*The Native 1920 x 1200 resolution, 7000 lumens, 24 x 7 operations, cable management and custom skins are stand alone with this incredible platform.*

**Ben Joy**  
InFocus Product Director



### Digital, Brilliant Colour

The IN5300 delivers a stunning combination of HD resolution and vivid detail in true-to-life colors with the latest DLP® DarkChip™ technology and InFocus' award-winning BrilliantColor™ implementation. For lasting brightness and colour that stays.

### High Resolution WXGA/WUXGA

With WXGA (1280 x 800) and WUXGA (1920 x 1200) native resolutions, the IN5500 series offers substantially wider space to display high resolution images for the next generation of operating systems and full high definition 1080p video.



**WXGA**  
1,280 x 800 PIXELS

**WUXGA**  
1,920 x 1,200 PIXELS

### Rich Connectivity

The IN5500 series features full analogue connectivity with HD15, BNC and component inputs, and HDMI 1.3 for the latest in Computer and HD Video connectivity. Engineered to be Wireless-Ready with LiteShow II, the IN5500 also includes embedded networking and RS232 control for full projector management over the network.

### Unique "Blue Iris" Glow Ring

The exclusive InFocus "Blue Iris" glow ring notifies users - from experienced to novice - when the projector is powering up or down. No more guessing what the "beep" or small "LED" means.

### Single or Dual Lamps

The IN5500 is available in single lamp for energy efficiency and low cost of ownership, or dual lamps for high brightness and fail-safe back-up protection.

### LiteShow II

The InFocus LiteShow II wireless adapter connects personal computers to InFocus digital projectors wirelessly. The high bandwidth 802.11 b/g connection supports simultaneous transmission of audio along with video/data content, providing a completely wireless multimedia presentation.

### 24/7 Non-Stop Projection

All new InFocus DLP® projectors are filter-free and are rated for 24/7 fail-safe operation, resulting in less maintenance and hours of worry-free use.

### LiteTouch Keypad

The sleek backlit LiteTouch control panel provides one-touch access to the most commonly used projector functions.



### High Performance Optics

Built-in horizontal and vertical lens shift allows mechanical alignment without optical distortion to retrofit legacy installations. Automatic sensors for ceiling detection and keystone means you will have a crisp, square image everytime. Pincushion/Barrel Distortion eliminates image warping and enables the IN5500 to project perfect images even on imperfect surfaces.

### Projector Management

Control at your fingertips. The IN5500's built-in web browser allows network administrators to remotely access and control the projector over standard LAN/WAN. The series is compatible with ProjectorNet 3.0, our free asset management software that enables you to conserve projector lamp life by scheduling On/Off times, and presetting maintenance events and anti-theft security alerts.

### Dynamic Messaging System

Send dynamic messages for instant display to InFocus projectors using the InFocus Dynamic Messaging System (DMS). Perfect for general and important announcements such as schedule changes, weather warnings, breaking news and emergency notifications.

### Horizontal and Vertical Lens Shift

Motorized lens shift  
- vertical 110% to -50%, horizontal +/-60%

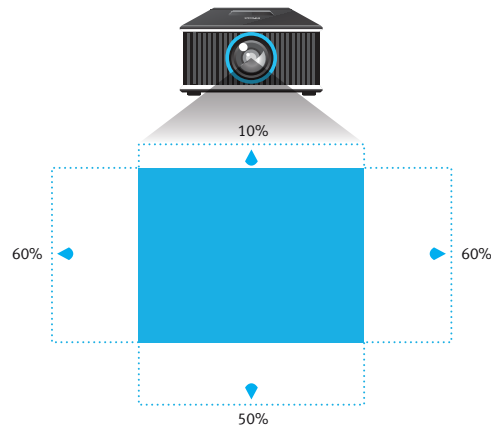

### Intuitive and Easy to Use Interface

Over 20 years of customer feedback has gone into designing the IN5500's best-in-class menu system. It is easy to navigate, has 17 standard languages and a unique intuitive flow.

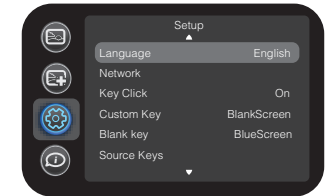

### Unique Cable Management System

The integrated cable management system provides easy access to the rich connector panel, while aligning each cable to the cable router. The result: 100% hidden cables that look as good as the rest of your room.



### SplitScreen™

Project images from 2 sources simultaneously and in a variety of configurations with InFocus SplitScreen™ technology. Perfect for viewing multiple presentations, videoconferencing and distance learning.



Unique Cable Management System

InFocus Optics Laboratory

## Optional Accessories

Projection Screens  
Cables & Adaptors  
Security Lock (SEC-LOCK-01)  
Replacement Lamps IN5502/04/32/34 (SP-LAMP-055)  
IN5532/34 series (SP-LAMP-056)  
LiteShow II Wireless Adapter (INLITESHOW2)  
Ceiling Mount SP-CEIL-INSTALL  
Remote Commander HW-COMMANDER-2  
Fixed Short Throw Lens (LENS-050)  
Wide Zoom Lens (LENS-051)  
Long Throw Lens (LENS-052)  
Ultra Long Throw Lens (LENS-053)  
Skin Kit / Glossy Black TOP-05-GB  
Skin Kit / Matte White TOP-05-MW  
Skin Kit / Walnut TOP-05-W  
Skin Kit / Primer TOP-05-B



## DisplayLink™

Hassle-free, lightning fast-projection. DisplayLink™ Content over USB technology eliminates the need for bulky VGA cables and allows for computer and image set up in seconds without toggling or cumbersome function key combinations. DisplayLink™ makes projecting simple!

## Warranty

Providing the highest quality products and support is very important to InFocus. The IN5500 series of digital projectors come standard with a 2-year limited factory warranty (including parts and labor) a 6 month limited lamp replacement warranty and 5 year DLP® warranty. Extended product and lamp warranty programs are also available. For more information, please visit: [www.infocus.com/service](http://www.infocus.com/service)

## Interchangeable Lenses

Interchangeable lenses provide greater flexibility for a large variety of applications – from short throw to ultra long throw projection.



## IN5500 (SERIES) FEATURES

- 2-3 Pull Down
- 2x/3x Color Wheel Option
- Auto Keystone
- BrilliantColor™
- Cable Management System
- Centered Lens
- Closed Captions
- Configurable Skins
- Dynamic Messaging
- Electrical H&V Keystone Correction
- Exhaust Vent on the Rear Side
- Freeze Frame with Magnifying Function
- InFocus UI
- Lamp Door on Side
- Logo Capture
- Low Power Standby (<1W)
- Motorized Focus and Zoom
- Motorized Lens Shift
- Picture-in-Picture
- Pin Cushion/Barrel Distortion Correction
- Plug & Play (DDC2B)
- Sleep Timer
- SNMP Capable
- Top Access Lamp
- Touchsense Keypad (LiteTouch™)
- USB Key JPG Reader (LitePort™)
- Vertical and Horizontal SplitScreen™
- WEB Browser Control
- Wireless Ready

**InFocus**  
Bright Ideas Made Brilliant

[www.infocus.com](http://www.infocus.com)

**INFOCUS CORPORATE HEADQUARTERS**  
27500 SW Parkway Avenue  
Wilsonville, Oregon 97070-9215, USA  
Phone: (1) 503-685-8888  
Toll Free: (1) 800-294-6400  
Fax: (1) 503-685-8887

**INTERNATIONAL HEADQUARTERS**  
19 Tanglin Road, 7th Floor  
Singapore 247909  
Phone: (65) 6334-9005  
Fax: (65) 6333-4525



©2009 InFocus Corporation. All rights reserved. Specifications are subject to change without further notice. InFocus and InFocus Bright Ideas Made Brilliant are either trademarks or registered trademarks of InFocus Corporation in the United States and other countries. DLP, the DLP logo, and the DLP medallion are trademarks of Texas Instruments. All trademarks are used with permission or are for identification purposes only and are the property of their respective companies. WB\_IN5500\_APAC\_210808. Part Number: MMINFOCUS-0204

# Specifications\*

	IN5502	IN5532	IN5504	IN5534
Native Resolution	IN5502 & IN5532 – WXGA 1280 × 800 IN5504 & IN5534 – WUXGA 1920 × 1200			
Maximum Resolution	WUXGA (1920 × 1200)			
Display Technology - DMD	IN5502 & IN5532 – DLP® .65" WXGA, DarkChip™ IN5504 & IN5534 – DLP® .67" WUXGA, DarkChip™			
Brightness	IN5502 & IN5504 – 5000 ANSI Normal Mode, 4,000 Eco Mode IN5532 & IN5534 – 7000 ANSI Normal Mode, 5,500 Eco Mode			
Lamp Life**	2500 Hrs Eco Mode (2000 Hrs Normal)			
Contrast Ratio	2000:1 Typical			
Audible Noise	29 db Eco Mode (30 db High Power)			
Computer Compatibility	PC, MAC			
Lenses	IN5502 & IN5532		IN5504 & IN5534	
Standard (inc)	1.52-2.03	1.33x	1.45-1.93	1.33x
Fixed (LENS-050)	0.81		0.77	
Wide Zoom (LENS-051)	1.27-1.52	1.2x	1.21-1.45	1.2x
Long Zoom (LENS-052)	2.03-3.85	1.9x	1.93-3.67	1.9x
Ultra Long (LENS-053)	3.85-7.32	1.9x	3.67-6.97	1.9x
Lens Shift Type	Motorized			
Lens Shift - Vertical	110% to -50%			
- Horizontal	+/- 60%			
Colorwheel	RGBYW / 5 Segment			
Number of Color	1.07 Billion			
Aspect Ratio	Native 16:10 (4:3, 5:4, 16:9 Supported)			
Lamp Configuration	IN5502 & IN5504 – 1 ea 330w lamp IN5532 & IN5534 – 2 ea 330w lamp			
Zoom/Focus	Power Focus Power Zoom			
Synch - Horizontal Scan Freq	15 ~ 100kHz (Video/PC)			
- Vertical Scan Freq	50 ~ 85Hz (Video/PC)			
Video Compatibility	NTSC / PAL / SECAM / PAL-M, N / NTSC4.43 SDTV: 480i, 480p, 576i, 576p HDTV: 720p, 1080i, 1080p (60,30,24Hz)			
Audio	5W x 2			
Input Sources	15pin Dsub x 2, RGBHV BNC, DisplayLink, LitePort HDMI x 2, Component, S-Video Composite Stereo Mini x 2, RCA Stereo x 3			
Output Sources	15pin Dsub Stereo-Mini Jack x 1			
Control - Wired Remote	2.5mm Stereo Mini			
- Control	RS232 Dsub-9, LAN, Wired Remote			
Screen Trigger	3.5mm Mini 12VDC 250ma			
Network	10 BASE-T, 100 BASE-TX			
Product Weight	44.1 lbs / 20.0 kg			
Product Dimensions - W×D×H	17.0 x 26.38 x 9.45 in / 432 x 670 x 240 mm			
Product Colour	Matte Black, Glossy Black, Matte White, Walnut, Primer for Customization			
Remote Control	Navigator - 3			
Ships With - Accessories	RGB Cable, Power Cord, USB Mini-G to A, Remote, Safety Instruction, Projector User's Guide, Display Link User's Guide			
Menu Languages	English, French, German, Italian, Korean, Portuguese, Russian, Spanish, Traditional Chinese, Simplified Chinese, Norwegian, Swedish, Finnish, Danish, Dutch, Polish, Turkish			
Regulatory Models	F5500 (IN5502, IN5504); F5530 (IN5532, IN5534)			
Approvals	UL60950-1/cUL (USA and Canada), FCC Part 15, Class A (USA), CE (Europe), NOM (Mexico), S-Mark (Argentina), GOST (Russia), KC (Korea), SAFETY Mark (Singapore), CCC, CECP (China), C-Tick (Australia/NZ)			
Security	Kensington Lock			

\* Product specifications, terms, and offerings are subject to change at any time without notice.

\*\* Actual lamp life may vary based on the ambient environment and projector usage. Conditions that may affect lamp life include temperature, altitude, and rapidly switching the projector on and off.